

Schedule 'A1-2'

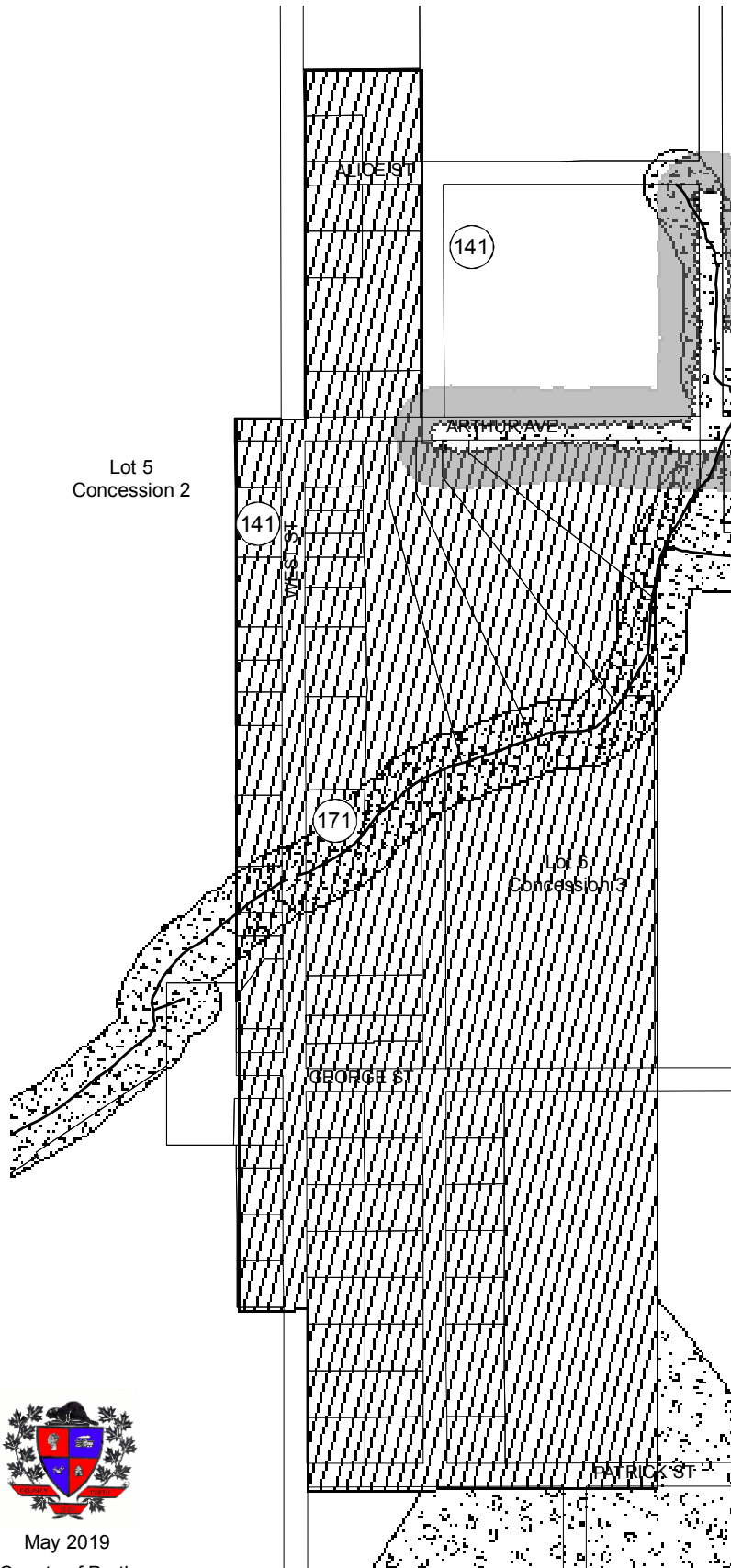



Trowbridge

Municipality of North Perth - Elma Ward

AMENDED BY OPA: 47
141
171

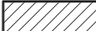

Legend

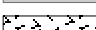
-  Village
-  Agriculture
-  Primary or Secondary Aggregate Resource
-  Natural Resources/Environment
-  NRE Adjacent Land/ Buffer Area
-  Adjacent Land

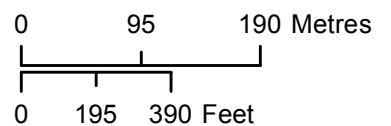

May 2019

County of Perth
Planning & Development Department