

# Schedule 'A2-2'

Amended By OPA: 6  
47  
141

## Molesworth Municipality of North Perth - Wallace Ward

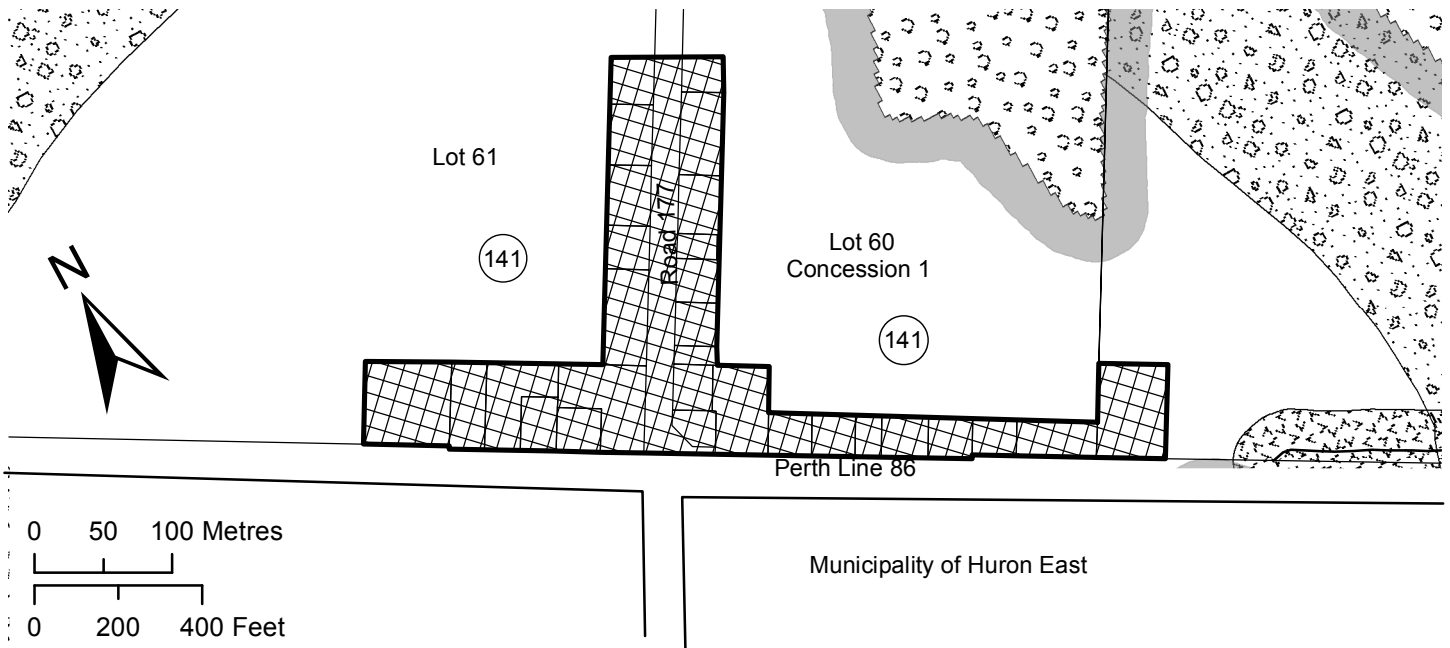



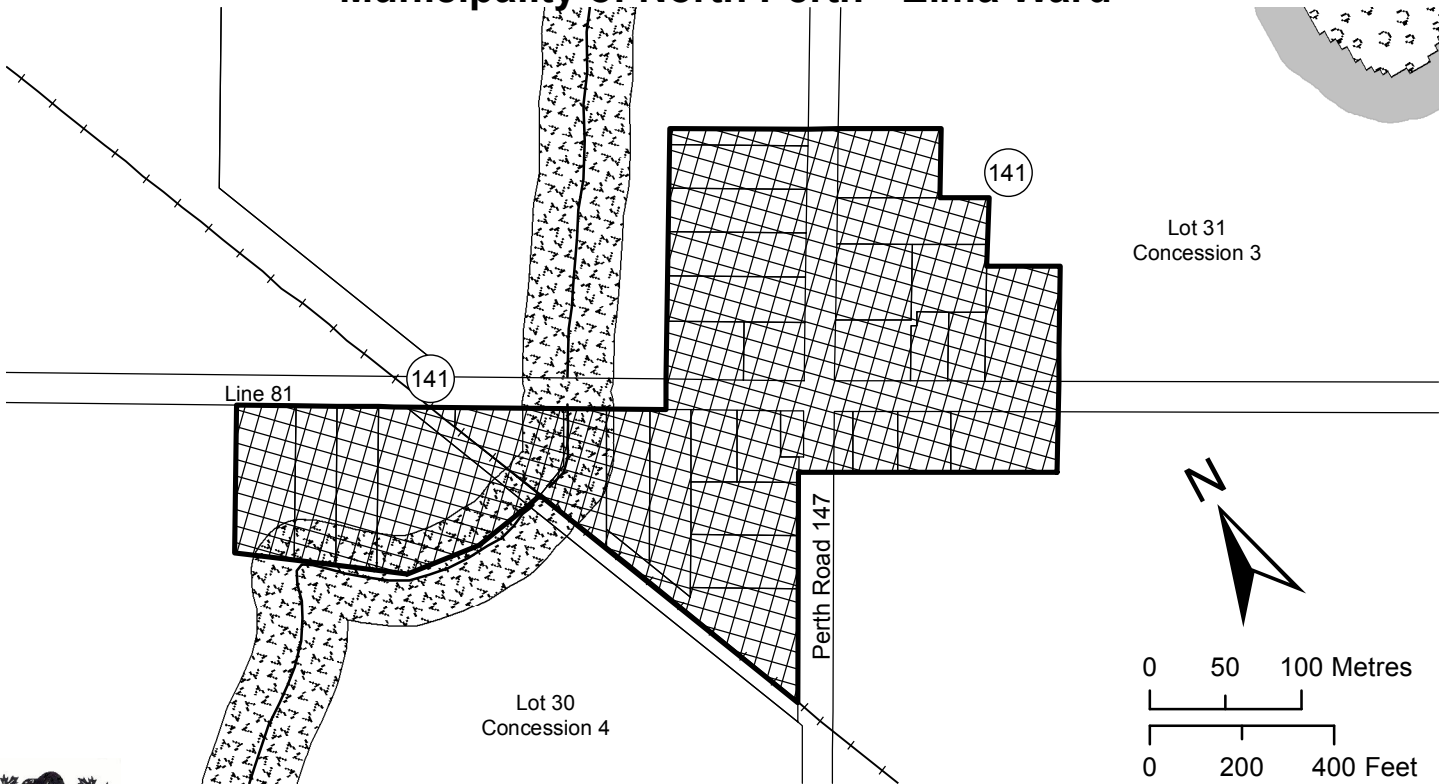

# Schedule 'A2-3'

Amended By OPA: 47  
109  
141

## Britton Municipality of North Perth - Elma Ward

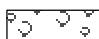
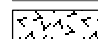

### Legend

- |   |             |   |                                      |   |                                 |
|---|-------------|---|--------------------------------------|---|---------------------------------|
|  | Hamlet      |  | Primary/Secondary Aggregate Resource |  | NRE Adjacent Land / Buffer Area |
|  | Agriculture |  | Natural Resources / Environment      |  | Adjacent Land                   |

