

**SCHEDULE 'B'
SHAKESPEARE
LAND USE
DESIGNATIONS**

Refer to Schedule
'B' Perth East Land
Use Designations

LOT 23 CON I LOT 22 CON I LOT 21 CON I LOT 20 CON I LOT 19 CON I

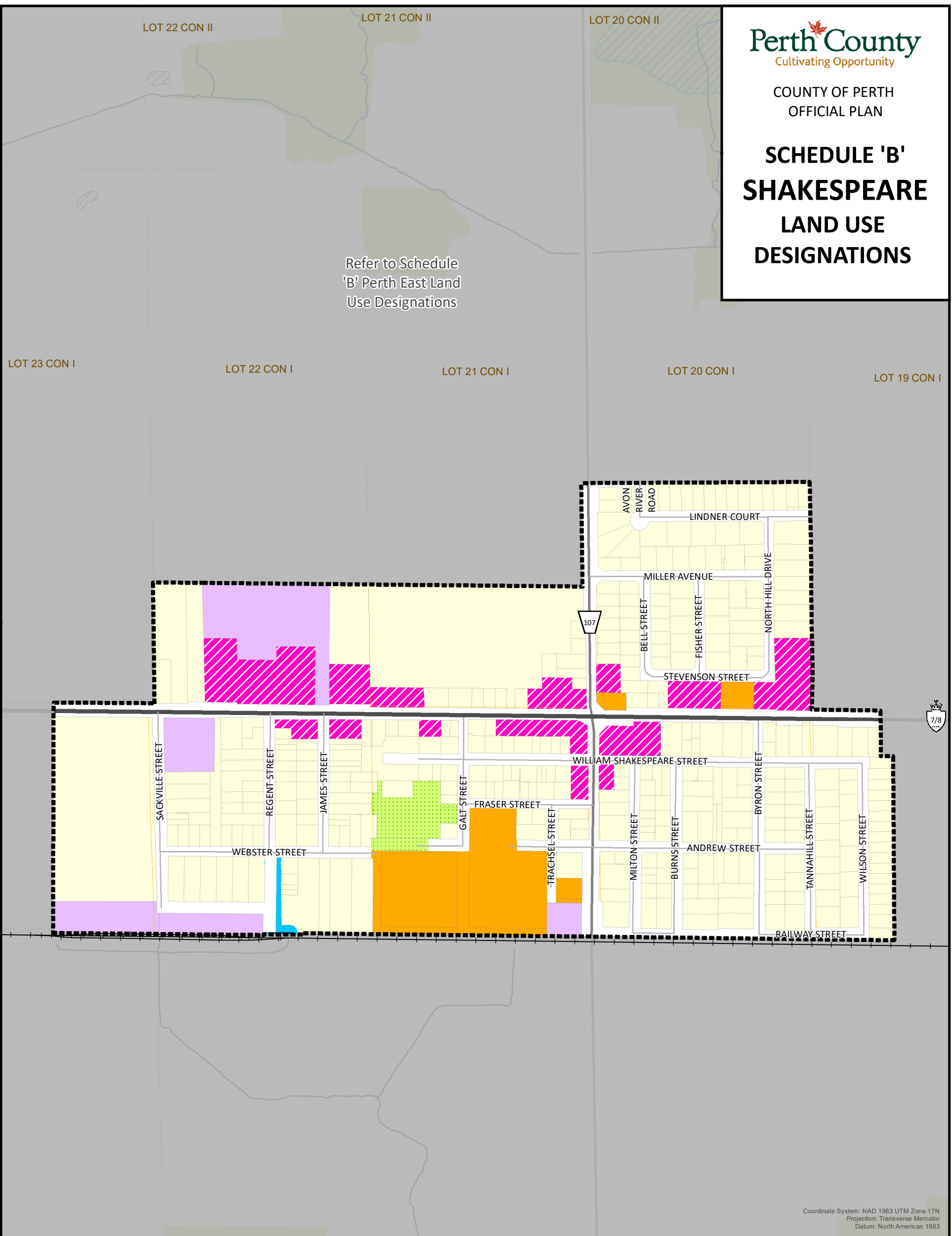

Coordinate System: NAD 1983 UTM Zone 17N
Projection: Transverse Mercator
Datum: North American 1983

LEGEND

Land Use Designations

- Open Space
- Neighbourhood
- Urban Mixed Use
- Employment
- Institutional

Floodplain

Additional Features

- Provincial Highway
- County Road
- Local Road
- Watercourse
- Railway/ Right of Way

- Settlement Area Boundary
- Lots and Concessions
- Parcels

0 80 160 240 m
Scale 1:7,000
1 cm = 70 m



This schedule forms a part of the County of Perth Official Plan and must be read in conjunction with applicable policies of the Plan. For accurate reference recourse should be had to the original document and amendments hereto. The County of Perth does not warrant the accuracy, completeness, content, or currency of the information provided. Contains information licensed under the Open Government Licence – Ontario. This is not a legal Plan of Survey. © The Corporation of Perth County, 2024.

This map may incorporate data under license from:
© King's Printer for Ontario, 2024
© Maitland Valley Conservation Authority, 2024
© Upper Thames River Conservation Authority, 2024
© Grand River Conservation Authority, 2024
© Ausable Bayfield Conservation Authority, 2024