

DRAFT

**SCHEDULE 'B'
ROSTOCK
LAND USE
DESIGNATIONS**

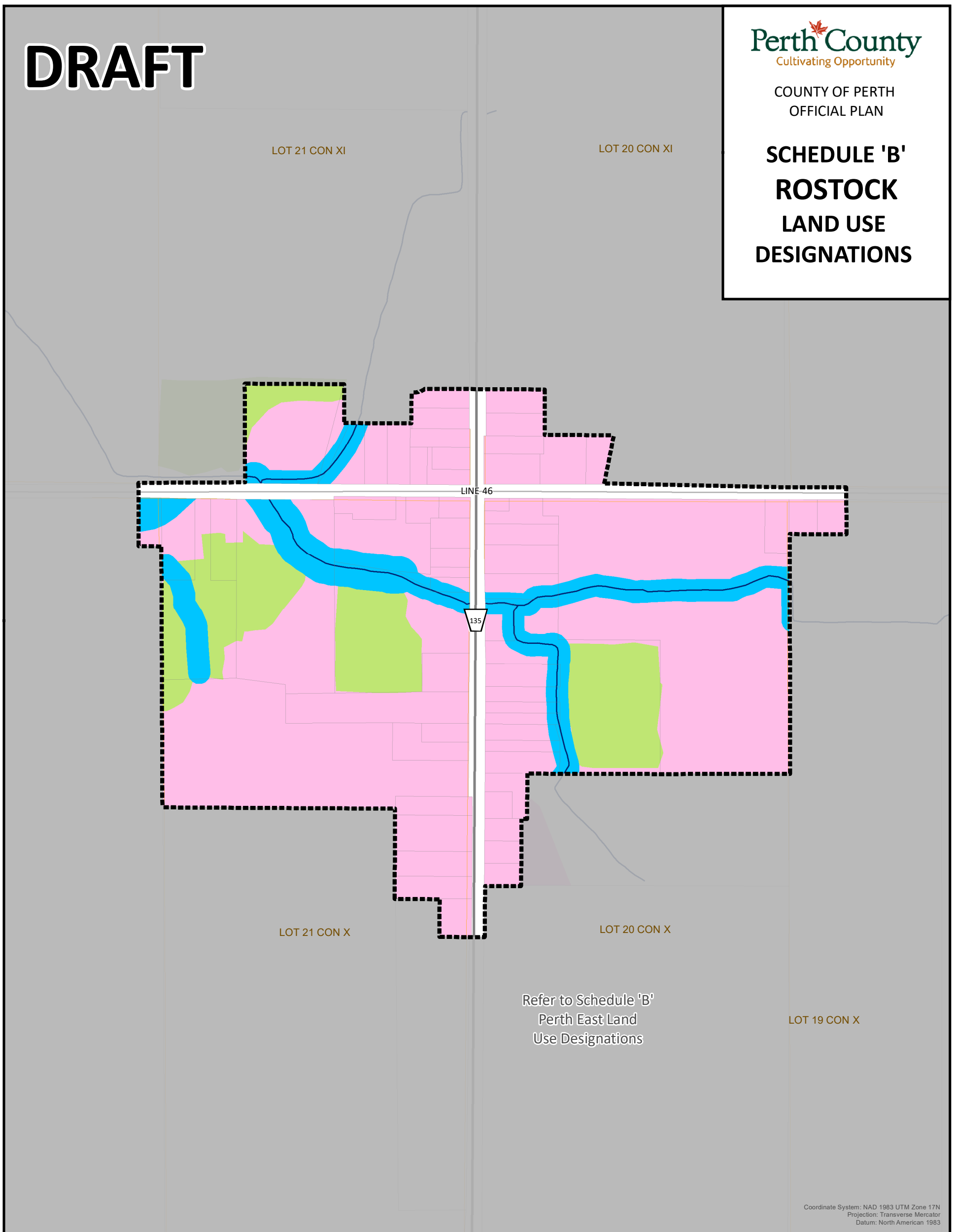

Refer to Schedule 'B'
Perth East Land
Use Designations

Coordinate System: NAD 1983 UTM Zone 17N
Projection: Transverse Mercator
Datum: North American 1983

LEGEND

Land Use Designations

- Natural Environment
- Village
- Floodplain

Additional Features

- County Road
- Local Road
- Watercourse
- Settlement Area Boundary
- Lots and Concessions
- Parcels

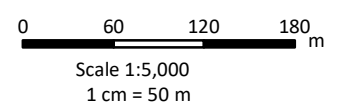

This schedule forms a part of the County of Perth Official Plan and must be read in conjunction with applicable policies of the Plan. For accurate reference recourse should be had to the original document and amendments hereto. The County of Perth does not warrant the accuracy, completeness, content, or currency of the information provided. Contains information licensed under the Open Government Licence – Ontario. This is not a legal Plan of Survey. © The Corporation of Perth County, 2023.

This map may incorporate data under license from:
© King's Printer for Ontario, 2023
© Maitland Valley Conservation Authority, 2023
© Upper Thames River Conservation Authority, 2023
© Grand River Conservation Authority, 2023
© Ausable Bayfield Conservation Authority, 2023