

**SCHEDULE 'B'  
MITCHELL  
LAND USE  
DESIGNATIONS**

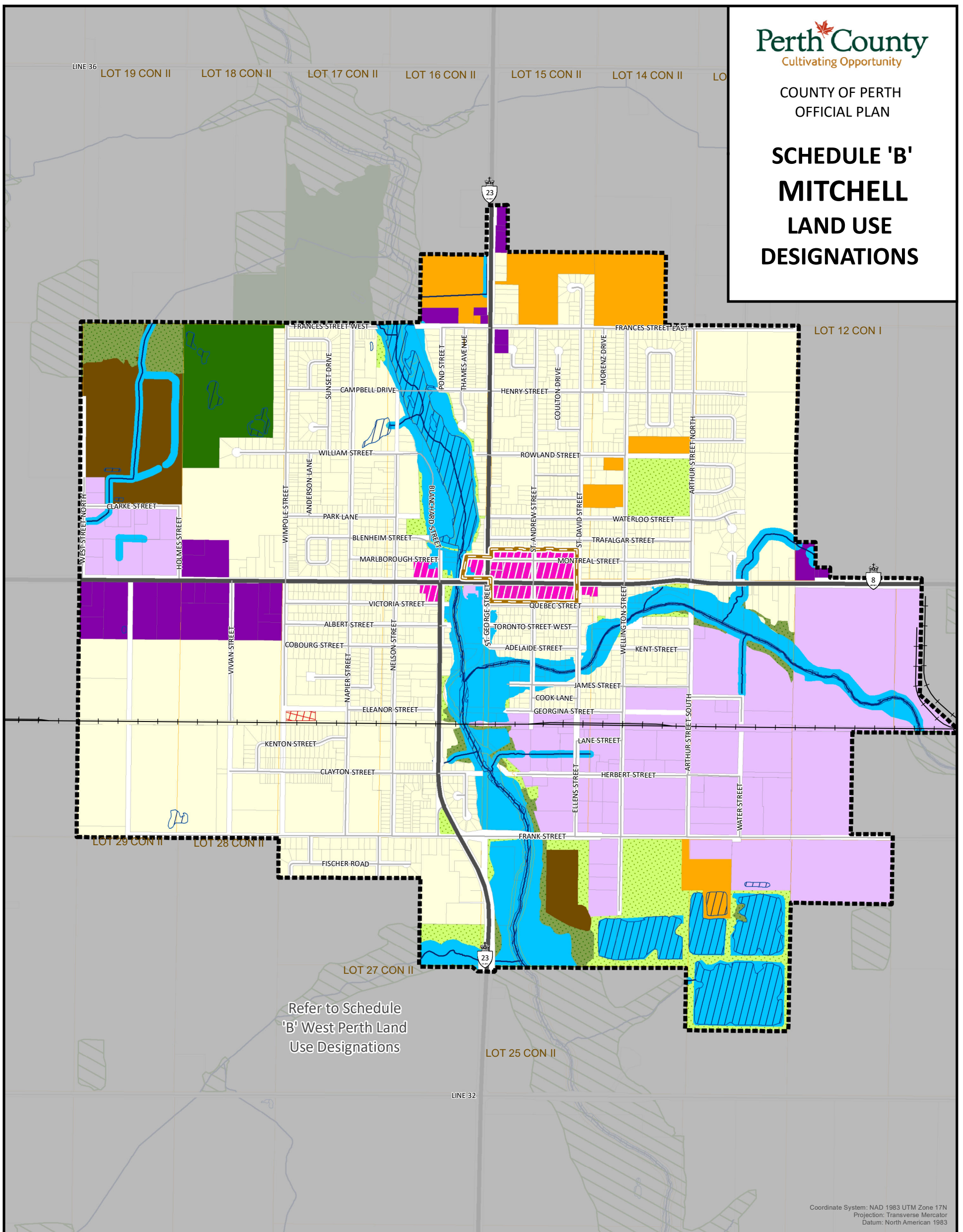

Refer to Schedule  
'B' West Perth Land  
Use Designations

Coordinate System: NAD 1983 UTM Zone 17N  
Projection: Transverse Mercator  
Datum: North American 1983

**LEGEND**

**Land Use Designations**

- |  |                     |  |                                   |
|--|---------------------|--|-----------------------------------|
|  | Open Space          |  | Employment                        |
|  | Natural Heritage    |  | Institutional                     |
|  | Recreation          |  | Open Landfill                     |
|  | Neighbourhood       |  | Floodplain                        |
|  | Urban Mixed Use     |  | Natural Heritage Features Overlay |
|  | Corridor Commercial |  |                                   |

**Additional Features**

- |  |                       |  |                          |
|--|-----------------------|--|--------------------------|
|  | Provincial Highway    |  | Strategic Growth Area    |
|  | County Road           |  | Settlement Area Boundary |
|  | Local Road            |  | Waterbody                |
|  | Railway/ Right of Way |  | Closed Landfill          |
|  | Watercourse           |  | Parcels                  |
|  |                       |  | Lots and Concessions     |

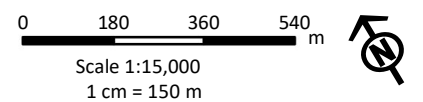

This schedule forms a part of the County of Perth Official Plan and must be read in conjunction with applicable policies of the Plan. For accurate reference recourse should be had to the original document and amendments hereto. The County of Perth does not warrant the accuracy, completeness, content, or currency of the information provided. Contains information licensed under the Open Government Licence – Ontario. This is not a legal Plan of Survey. © The Corporation of Perth County, 2025.

This map may incorporate data under license from:  
© King's Printer for Ontario, 2024  
© Maitland Valley Conservation Authority, 2024  
© Upper Thames River Conservation Authority, 2024  
© Grand River Conservation Authority, 2024  
© Ausable Bayfield Conservation Authority, 2024